

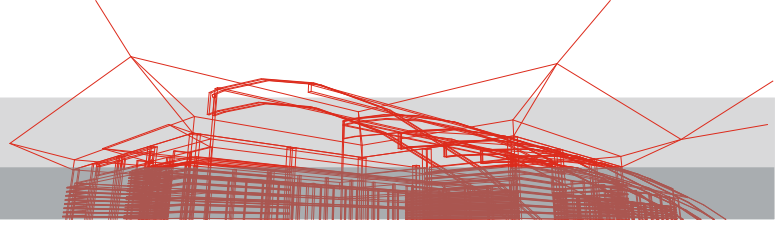

EXPOSYSTEM
WE KNOW HOW



Contents

* Company Profile	1
* Benefits - Standard Stand Structure	2
* Special Construction Stands	3 - 5
* Special Construction Order Form	6
* Special Design Stands	7 - 8
* Stand Equipment: chair - stool - sofa	9
* Stand Equipment: table - office	10
* Furniture Order Form 1	11
* Stand Equipment: Showcase - Infodesk	12
* Stand Equipment: Locker - brochure stand	13
* Showcase - Infodesk Order Form 2	14
* Stand Equipment: Shelf - Basic structure element - door	15
* Structure Element Order Form 3	16
* Stand Equipment: Floor - Roof	17
* Floor - Roof Order Form 4	18
* Stand Equipment: Electrical equipment - Audiovisual	19
* Electrical equipment - hydro-sewerage Order Form 5	20
* Stand Equipment: Suspension	21
* Suspension - Audiovisual Order Form 6	21

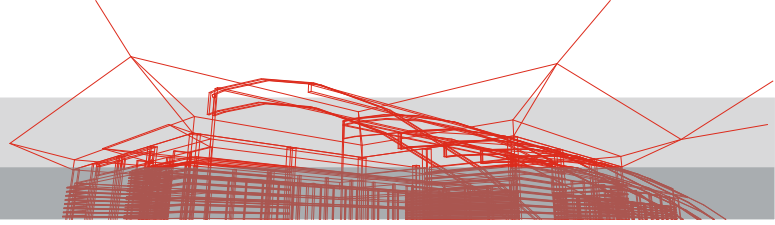

The provision of services to the exhibitions' organizers and the exhibitors is based on the cooperation of Mediterranean Exhibition Center (MEC) and the companies Mediterranean National Exhibitions sa (MEDE), the manager company of the Exhibition Center and on the Construction Exhibition Company Exposystem sa.

Company profile

Exposystem was established in 1993 in Thessaloniki. In 2000, having developed the company's activity in Athens, there is an agreement between MEC and Exposystem undertaking an important number of exhibitions. In 2013 a branch of Exposystem in Athens, in area of Anthousa is established.

The company is made up from Sales department, production department, implementation department and accounting department. The sales department consists of expert salesmen with special knowledge of exhibition marketing, as far as designers with expertise in innovative Design.

The production and implementation departments are based in the 8.500sqm of the company facilities in the industrial are of Sindos, in Thessaloniki.

The accounting department is based in the central offices of the company and at the branch in Athens. Its activity is based on a computerized software of communication(ERP) that is responsible for the good transition of information and the final formatting of the product.

The biggest exhibition and political, marketing and cultural events' organizers plus an important list of private companies is a «quality heritage» that makes the responsibility bigger and it is a guarantee for a better future with many more quality and creative exhibitions.

Nowadays Exposystem is the biggest company in the exhibition market in Greece, providing the exhibition and event organizers and exhibitors the following services.

- Exhibition Marketing
- * Exhibition Architecture
- * Basic design structure for Exhibitions - Congresses
- * Congress stand of special design structure
- * Renting furniture
- * Renting audio visual equipment
- *



Basic aluminum stand

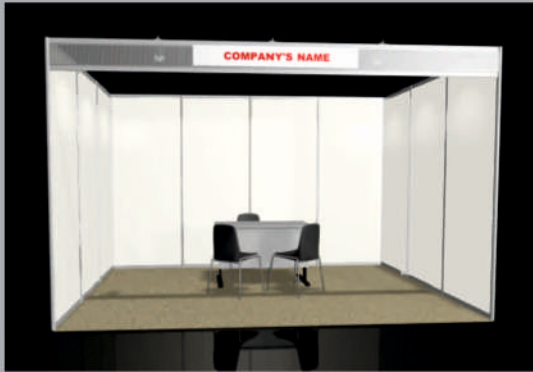

Basic aluminum stand with 1 front view



Basic aluminum stand with 2 views



Basic aluminum stand with 3 views

 Detailed dimension of the stand
 The inside height is 2.4m

The structure of basic aluminum stand has 2.50m height which has an aluminum beam of Octanorm company.

The colour of the aluminum structure is silver and the panels which made from mdf, are of white colour.

At the entrance of the stands there is an aluminum perforated fascia with another pvc fascia on the front. Its height is 30cm whereas the pvc fascia has 20cm height.

The pvc fascia is of 1.50x0.20m height with the exhibitors' logo and stand number and the exhibition logo printed on it.

On the roof, we place Octanorm aluminum beam of 5.50cm height. On the floor we place carpet with the color that exhibitor prefers.

The furniture and electrical equipment for the basic aluminum stand are on exhibitors' preference.

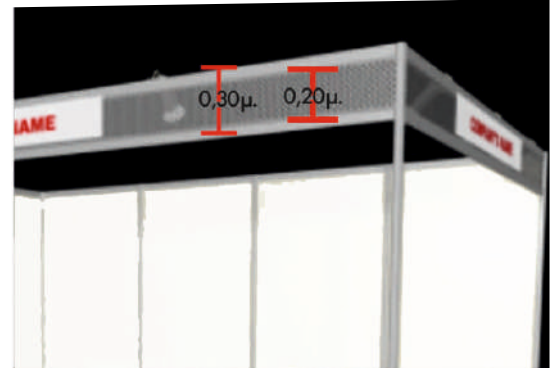

Detailed dimension of fascia

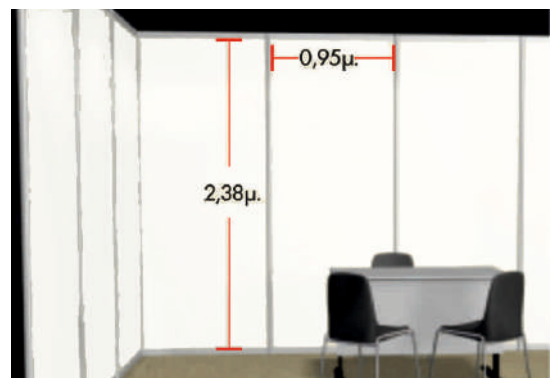

Detailed dimension of panels



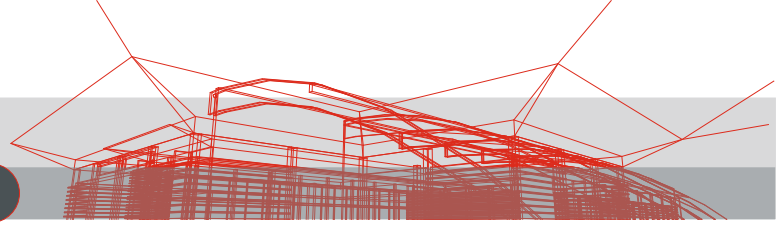

CODE: 9999-191

Description

- Construction type:** Aluminum type **MAXIMA M1000 OCTANORM** 2.5m height
- Carpet:** Grey Elea Vel 5 15
- Panel:** PVC white colour
- Storage:** It is structured as 1.00x1.00m with wooden door of white colour
- Info Desk:** White colour wooden infodesk with brochure stand made of plexi glass

- Equipment:**
- 1 round glass table d90
 - 3 white/grey chairs
 - 1 stool
 - 1 HQL spot 150watt/4sqm
 - 1 socket 500 watt

- Printings:** A printing sticker of 0.964x2.38m height is provided. It is also provided a printing sticker on lightbox of 0.914x2.38m height.
More printings can be printed with 26€/sqm

* They are provided in stands of 12sqm and more



Description

Construction type: Wooden walls (MDF) 5m length x4.00m width and 3.00m height in white colour

Carpet: Dark Grey Elea Vel .

Equipment:

- ✿ 1 round glass table d90
- ✿ 3 black chairs
- ✿ 1 stool
- ✿ 1 socket 500 watt

Printings: There is a wooden fascia of 0.50m height where a logotype is printed on

*** They are provided in stands of 16sqm and more**

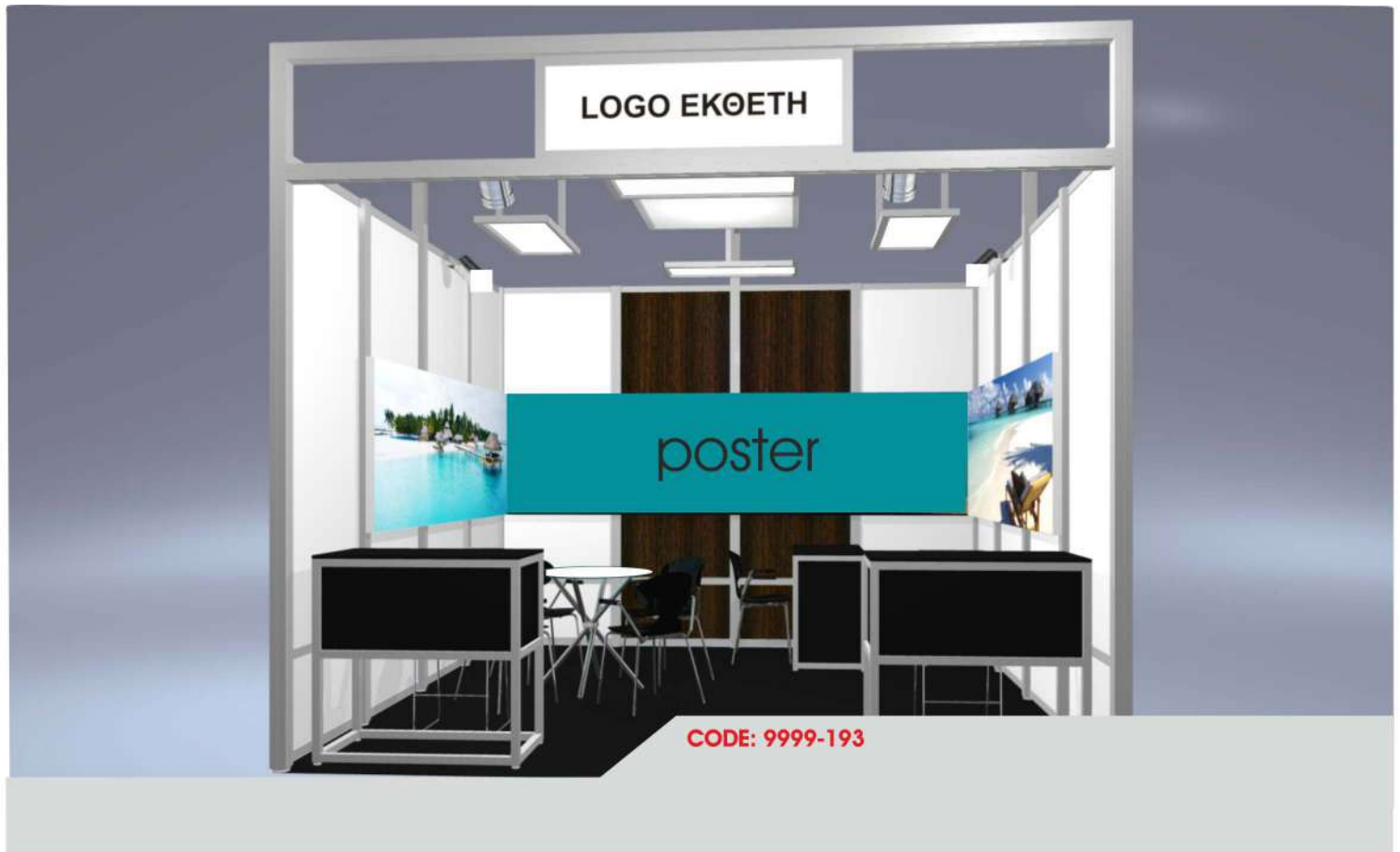

CODE: 9999-193

Description

Construction type: Aluminum type **MAXIMA M1000 OCTANORM** 3.00m height

Carpet: Black Alma Elea Vel.

Panel: Synthetic leather of white colour and wenge

Roof: Alluminum structure 1.00x1.00m & 1.00x0.50m in different heights covered with white panels

- Equipment:**
- 1 round glass table d90
 - 6 black chairs
 - 2 stools
 - 2 infodesks
 - 1 HQI spot 150watt/4sqm
 - 2 power strips of two sockets, 500 watt
 - 4 HQI spots
 - 1 B2B position

Printings: It is provided a printing sticker on lightbox of 0.1.50x0.50m height. They are also provided 2 printings on vinyl. One with dimension 3.00x1.00m height and one with 4.00x1.00m height

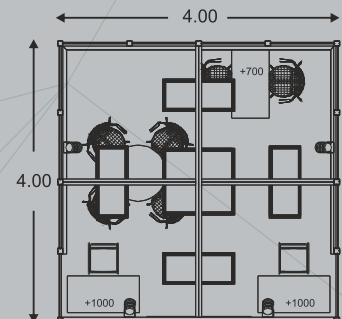

* They are provided in stands of 16sqm and more

ORDER FORM SPECIAL CONSTRUCTION

IT HAS TO BE SENT 10 DAYS BEFORE THE OPENING DAY

Please contact: Mrs. Izabela Kuch e-mail: mec@exposystem.gr Mrs. Chletsou e-mail: mchletsou@exposystem.gr
Tel. / Fax: 0030 210 6659741 & 0030 210 3511885

STAND NUMBER :

EXHIBITION : Exhibition Centre

COMPANY NAME : Person at response :

V.A.T. number : TEL : FAX :

PROFESSION : ADDRESS : P.O.

CODE	DESCRIPTION	€ / SQM	SQM	COST
9999-191	EXPO 1	35		
9999-192	EXECUTIVE STAND	45		
9999-193	BUSINESS STAND	55		

SIGNATURE & COMPANY STAMP

NET PRICE

V.A.T. 24%

TOTAL PRICE

DATE.....

The order is valid only in case that you have proceed a bank deposit 10 days before exhibition's opening day, to the following Bank Account **ETHNIKI Bank (IBAN: GR13 011 084 000000 840 470 23795)**

Please inform us about your deposit by sending to EXPOSYSTEM the deposit receipt by fax.

Orders which made on site during one day before exhibition's opening day, are fulfilled according our remaining items in storage and the service is according to the orders list.

Over 30 years of experience in the field of **EXHIBITIONS, EVENTS & CONGRESSES** establishes **EXPOSYSTEM S.A.** as the leading Greek company for CONTEMPORARY INTEGRATED PROMOTING SOLUTIONS.

Our company projects customer needs into solid 3D designs, within the specifications of each exhibition and increases the impact of its clients' participation both in Greece and abroad.

Με πάνω απο 30 χρόνια εμπειρίας στους τομείς των εκθέσεων, εκδηλώσεων & συνεδρίων, η **EXPOSYSTEM** αποτελεί την κορυφαία ελληνική εταιρεία στα **ΣΥΓΧΡΟΝΑ ΟΛΟΚΛΗΡΩΜΕΝΑ ΣΥΣΤΗΜΑΤΑ ΠΡΩΩΘΗΣΗΣ**.

Η εταιρεία μας σχεδιάζει τις ανάγκες των πελατών της σε τρισδιάστατη παρουσίαση, σύμφωνα με τις προδιαγραφές της κάθε έκθεσης και αυξάνει την παρουσία των πελατών της σε συμμετοχές τόσο στην Ελλάδα, όσο και στο εξωτερικό.

EZA



Nespresso



Bristot



Loux



Nasopoulos



AthinaikiZithopoia



tent 5x5 in external space



Exposystem specializes in:

- Customized constructions
- Standard & complex modular structures
- Printing, Audiovisual & Equipment
- Event & Congress Organization
- Design & Implementation of Team Entries

Η Exposystem ειδικεύεται σε:

- Ειδικές εκθεσιακές κατασκευές
- Απλές και σύνθετες δομές περιπτέρων
- Εκτυπώσεις, οπτικοακουστικά & εξοπλισμός
- Οργάνωση εκδηλώσεων & συνεδρίων
- Σχεδιασμό & Υλοποίηση ομαδικών συμμετοχών

JTI



tent 5x5 in external space



100% Hotel Show



Enterprise



Congresses - Events





beige chair
polyester
code.9999-M095



atlanta chair
veraman polyester
code.9999-M033



jodi chair
black leather
code.9999-M034



portoghese armchair
oak
code.9999-M201



isis armchair
with blue polyester
code.9999-M039



isis armchair
beige polyester
code.9999-M040



isis armchair
red polyester
code.9999-M035



lisa armchair
brown leather
code.9999-M037



lisa armchair
blue leather
code.9999-M038



foster chair
white polyester
code.9999-M041

stool



zita stool
black
code.9999-07



jodi stool
black leather
code.9999-M183



bobo stool
white
code.9999-M043



348 stool
oak
code.9999-M042

sofa



two seater sofa
beige leather
code.9999-M046



two seater sofa
black leather
code.9999-M044



metallic coffee table
glass top / 0,50X0,50X0,45m
code.9999-M047



metallic coffee table
beige melamine / 0,50X0,50X0,45m
code.9999-M049



round oak table
D0,60 m
code.9999-M052



bar table
D0,60m height 0,85 m
code.9999-M054



glass council table
1,40X0,80X0,72 m
code.9999-M055



round glass table
D0,90 m
code.9999-M050



beige melamine table
1,20X0,70X0,72m
code.9999-M091



foldable table
small 140X0,76X0,72m
medium 1,80X0,76X0,72m
large 2,40X0,76X0,72m
code.9999-M089-M085-M084

office



beige melamine office with drawers
1,20X0,70X0,72m
code.9999-M090



oak office with tricyclic drawers
1,40X0,80X0,72 m
code.9999-M057



melamine office
grey
code.9999-M056



EXPOSYSTEM
imagine the exhibitions!

1

ORDER FORM FUNTITURE

IT HAS TO BE SENT 10 DAYS BEFORE THE OPENING DAY

Please contact: Mrs. Izabela Kuch e-mail: mec@exposystem.gr Mrs. Chletsou e-mail: mchletsou@exposystem.gr

Tel. / Fax: 0030 210 6659741 & 0030 210 3511885

STAND NUMBER :

EXHIBITION : Exhibition Centre

COMPANY NAME : Person at response :

V.A.T. number : **TEL** : **FAX** :

PROFESSION : **ADDRESS** : **P.O**

CODE	DESCRIPTION	€ / ITEM	ITEMS	COST
CHAIRS – ARMCHAIRS – SOFA				
9999-M095	BEIGE POLYESTER CHAIR	10€		
9999-M033	LIGHT GREEN ATLANDA CHAIR	15€		
9999-M034	BLACK JODI CHAIR	20€		
9999-M035	RED ISIS CHAIR	13€		
9999-M041	FOSTER WHITE POLYESTER CHAIR	14€		
9999-M040	BLUE ROLLING ARMCHAIR	30€		
9999-M039	LIGHT BROWN ROLLING ARMCHAIR	30€		
9999-007	BLACK BAR STOOL	22€		
9999-M0183	BLACK BAR STOOL WITH BACK-REST	28€		
9999-M042	LIGHT BROWN BAR STOOL WITH BACK-REST	28€		
9999-M043	WHITE BOBO STOOL	28€		
9999-M044	BLACK SOFA	85€		
9999-M045	BLUE SOFA	85€		
9999-M046	BEIGE SOFA	85€		
DESKS – TABLES				
9999-M048	SMALL BEIGE TABLE 0.90X0.50X0.45	15€		
9999-M049	SMALL BEIGE TABLE 0.50X0.50X0.45	11€		
9999-M050	ROUND TABLE WITH GLASS COVER D.0.90	35€		
9999-M052	ROUND TABLE WITH WOODEN COVER D. 0.70	27€		
9999-M054	WOODEN BAR TABLE D. 0.60, HEIGHT 0.85	38€		
9999-M055	GLASS CONFERENCE TABLE 1.40X0.80X0.72	60€		
9999-M091	BEIGE TABLE 1.20X0.70X0.72	25€		
9999-085	GREY MELAMINE FLAP TABLE MIDLE 1.80X0.76X0.72	38€		
9999-084	GREY MELAMINE FLAP TABLE LARGE 2.40X0.76X0.72	48€		
9999-M090	BEIGE DESK WITH DRAWERS 1.20X0.70X0.72	33€		
9999-M056	GREY WOODEN DESK WITH ROLLING DRAWERS 1.40X0.80X0.72	50€		
9999-M057	BEECH DESK WITH ROLLING DRAWERS 1.40X0.80X0.72	50€		

SIGNATURE & COMPANY STAMP

NET PRICE

V.A.T. 24%

TOTAL PRICE

DATE

The order is valid only in case that you have proceed a bank deposit 10 days before exhibition's opening day, to the following Bank Account: **ETHNIKI Bank (IBAN: GR13 011 084 000000 840 470 23795)** Please inform us about your deposit by sending to EXPOSYSTEM the deposit receipt by fax.

Orders which made on site during one day before exhibition's opening day, are fulfilled according our remaining items in storage and the service is according to the orders list.



illuminated
white wooden showcase
with glass shelves & 1 spot pl

0,35x0,80x2,00m

code.9999-M001

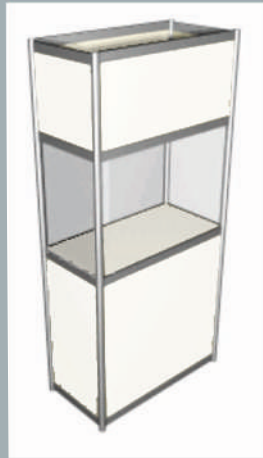

flooring jewelry showcase
with storage space

0,50X1,00X2,50 m

code.9999-M002



showcase with 2 glass shelves
and storage space
lighting with 3 spots 50watt

0,50X1,00X2,20m

code.9999-M003

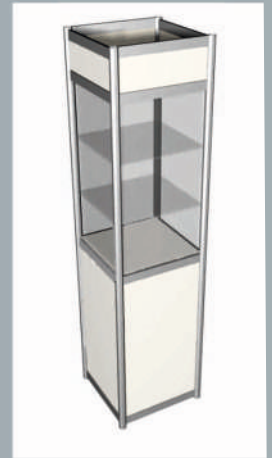

showcase of basic structure
with 2 glass shelves &
lighting with 2 spots 50watt

code.9999-M004



short showcase
with storage space

0,50X1,00X1,05m

code.9999-M005



shelves unit with
3 shelves

0,50X0,50X2,20m

code.9999-M006



shelves unit with
3 shelves

0,30X1,00X2,20m

code.9999-M007

infodesk



Infodesk with
plexiglass brochure case

1,20X0,50X1,05m

code.9999-M008



Rounded nfodesk

1,54X0,80X1,05m

code.9999-M012





corner bar

1,50X1,00X1,05 m

code.9999-M0 13

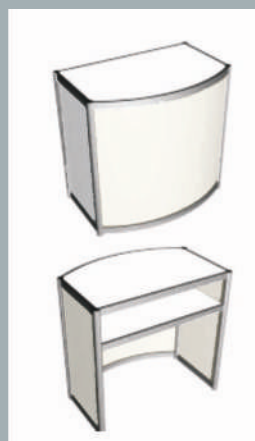

tv-video desk

1,00X0,70X1,05m

code.9999-M0 14

cupboards



grey cupboard

0,80X0,45X0,70 m

code.9999-M0 16



oak cupboard

0,80X0,45X0,70m

code.9999-M0 15

brochure stands

white appliance



mettalic brochure holder for 3 A4

code.9999-M02 1



fridge with 24h supply

code.9999-26



EXPOSYSTEM
imagine the exhibitions!

2

ORDER FORM SHOWCASES - INFO DESKS

IT HAS TO BE SENT 10 DAYS BEFORE THE OPENING DAY

Please contact: Mrs. Izabela Kuch e-mail: mec@exposystem.gr Mrs. Chletsou e-mail: mchletsou@exposystem.gr

Tel. / Fax: 0030 210 6659741 & 0030 210 3511885

STAND NUMBER :

EXHIBITION : Exhibition Centre

COMPANY NAME : Person at response :

V.A.T. number : **TEL** : **FAX** :

PROFESSION : **ADDRESS** : **P.O**

CODE	DESCRIPTION	€ / ITEM	ITEMS	COST
SHOWCASES – INFO				
9999-M001	ILLUMINATED WHITE SHOWCASE WITH GLASS SHELVES 0.35x0.80x2.00m	70€		
9999-M002	WHITE FLOOR SHOWCASE WITH 1 EXHIBITING LEVEL 0.50X1.00X2.20	55€		
9999-M003	WHITE FLOOR SHOWCASE WITH 2 GLASS SHELVES AND 3 SPOTS 0.50X1.00X2.50	62€		
9999-M004	WHITE FLOOR SHOWCASE WITH 2 GLASS SHELVES AND 2 SPOTS 0.50X0.50X2.50	47€		
9999-M005	WHITE SHORT SHOWCASE WITH GLASS COVER 0.50X1.00X1.05	36€		
9999-M006	SHELVES UNIT WITH 3 SHELVES 0.50X0.50X2.20	28€		
9999-M007	SHELVES UNIT WITH 3 SHELVES 0.50X1.00X2.20	32€		
9999-M012	OCTANORM WHITE CURVED INFO DESK WITH WHITE COVER 1.54X0.80X1.05	50€		
9999-M013	OCTANORM WHITE CORNER INFO DESK WITH WHITE COVER 1.50X1.00X1.05	52€		
9999-M014	OCTANORM WHITE TV-VIDEO DESK WITH WHITE COVER 1.00X0.70X1.05	52€		
9999-M016	GREY CUPBOARD 0.80X0.45X0.70	32€		
9999-M015	BEECH CUPBOARD 0.80X0.45X0.70	33€		
OTHERS				
9999-M021	METALLIC LITERATURE HOLDER FOR 3 A4	35€		
9999-26	SMALL FRIDGE WITH 24 HOUR SUPPLY	60€		

SIGNATURE & COMPANY STAMP

NET PRICE

V.A.T. 24%

TOTAL PRICE

DATE

The order is valid only in case that you have proceed a bank deposit 10 days before exhibition's opening day, to the following Bank Account: **ETHNIKI Bank (IBAN: GR13 011 084 000000 840 470 23795)** Please inform us about your deposit by sending to EXPOSYSTEM the deposit receipt by fax.

Orders which made on site during one day before exhibition's opening day, are fulfilled according our remaining items in storage and the service is according to the orders list.

Stand Equipment

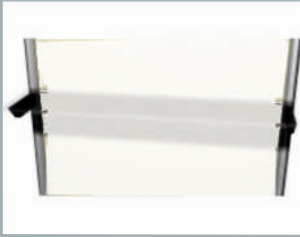

glass shelf 3kg stamina

1,10X0,30m

code.9999-M026



melamine shelf 8kg stamina

1,10X0,30m

code.9999-M027



melamine shelf inclined

1,10X0,35 m

code.9999-M028



storage self

code.9999-M029



white cube with white top

0,50,50X0,60 m

code.9999-M031



white cube with white top

0,50,50X0,80m

code.9999-M032

basic structure element



pvc panel

1,00X2,50m

code.9999-M024



glass panel

1,00X2,50m

code.9999-M023



basic construction

hunger

code.9999-24



floor coat

hunger

code.9999-25

door



folding door

1,00X2,50m

code.9999-29

alluminum door
with glass

1,00x2,50m

code.9999-30



wooden oak
door

1,00x2,50m

code.9999-M022

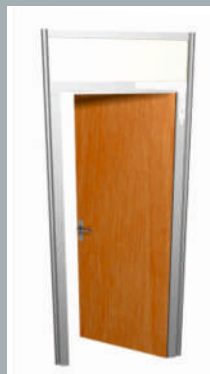

ORDER FORM PANELS – DOORS – SHELVES - CUBES

IT HAS TO BE SENT 10 DAYS BEFORE THE OPENING DAY

Please contact: Mrs. Izabela Kuch e-mail: mec@exposystem.gr Mrs. Chletsou e-mail: mchletsou@exposystem.gr
Tel. / Fax: 0030 210 6659741 & 0030 210 3511885

STAND NUMBER

EXHIBITION **Exhibition Centre**

COMPANY NAME : **Person at response** :

V.A.T. number : **TEL** : **FAX** :

PROFESSION : **ADDRESS** : **P.O**

CODE	DESCRIPTION	€ / ITEM	ITEMS	COST
PANELS – DOORS				
9999-M025	WHITE PVC PANEL 1.00X2.50	12€		
9999-M024	WHITE PVC PANEL 0.50X2.50	7€		
9999-M023	PANEL WITH GLASS OF 1.50 Height, 1.00X2.50	25€		
9999-0019	WHITE PVC PANEL 1.00X0.50	4€		
9999-24	CONSTRUCTION OF HUNGER 1.00X2.50	18€		
9999-25	FLOOR COAT HUNGER	10€		
9999-29	WHITE FOLDING DOOR	32€		
9999-30	ALUMINUM DOOR WITH GLASS	50€		
9999-M022	WOODEN BEECH DOOR	50€		
SHELVES – CUBES				
9999-M026	WALL GLASS SHELF 1.10X0.30, TILL 3kg WEIGHT	9€		
9999-M027	WOODEN WHITE SHELF 1.10X0.30, TILL 8kg WEIGHT	7€		
9999-M028	SLOPING WOODEN WHITE SHELF 1.10X0.30	8.5€		
9999-M029	SHELF FOR SMALL (1X1M) STORAGE 0.95X0.30	8€		
9999-M030	PAIR OF BRACKETS FOR WALL SHELVES	5€		
9999-M031	OCTANORM WHITE CUBE WITH WHITE COVER 0.50X0.50X0.60	10€		
9999-M032	OCTANORM WHITE CUBE WITH WHITE COVER 0.50X0.50X0.80	10€		

SIGNATURE & COMPANY STAMP

NET PRICE

V.A.T. 24%

TOTAL PRICE

DATE

The order is valid only in case that you have proceed a bank deposit 10 days before exhibition's opening day, to the following Bank Account: **ETHNIKI Bank (IBAN: GR13 011 084 000000 840 470 23795)** Please inform us about your deposit by sending to EXPOSYSTEM the deposit receipt by fax.

Orders which made on site during one day before exhibition's opening day, are fulfilled according our remaining items in storage and the service is according to the orders list.

nylon carpet



light beige

code.9999-M058



beige

code.9999-M059



bordeaux colour

code.9999-M060



light grey

code.9999-M061



grey

code.9999-M062



dark grey

code.9999-M063



light blue

code.9999-M064



blue

code.9999-M065



red

code.9999-M066



green

code.9999-M067

elevated floor with carpet

laminated parquet

- elevated floor 12cm with light beige carpet and nylon
- elevated floor 12cm with beige carpet and nylon
- elevated floor 12cm with bordeaux colour carpet and nylon
- elevated floor 12cm with light grey carpet and nylon
- elevated floor 12cm with grey carpet and nylon
- elevated floor 12cm with dark grey carpet and nylon
- elevated floor 12cm with light blue carpet and nylon
- elevated floor 12cm with blue carpet and nylon
- elevated floor 12cm with red carpet and nylon
- elevated floor 12cm with green carpet and nylon

placed on novopan



oak

code.9999-M078



maple

code.9999-M079

elevated floor with parquet

checked alluminum ceiling

lighting beam

fascia



elevated floor 12cm covered with oak parquet
code.9999-M080



code.9999-M082



code.9999-M083



code.9999-M084



EXPOSYSTEM
imagine the exhibitions!

4

ORDER FORM CARPET - ELEVATED FLOOR - CEILING

IT HAS TO BE SENT 10 DAYS BEFORE THE OPENING DAY

Please contact: Mrs. Izabela Kuch e-mail: mec@exposystem.gr Mrs. Chletsou e-mail: mchletsou@exposystem.gr

Tel. / Fax: 0030 210 6659741 & 0030 210 3511885

STAND NUMBER :

EXHIBITION : Exhibition Centre

COMPANY NAME : Person at response :

V.A.T. number : **TEL** : **FAX** :

PROFESSION : **ADDRESS** : **P.O**

CODE	DESCRIPTION	€ / ITEM	ITEMS	COST
NYLON CARPETS				
9999-M058	BLACK CARPET & NYLON	3,95€		
9999-M059	BEIGE CARPET & NYLON	3,95€		
9999-M060	BORDEAUX CARPET & NYLON	3,95€		
9999-M061	LIGHT GREY CARPET & NYLON	3,95€		
9999-M062	GREY CARPET & NYLON	3,95€		
9999-M063	DARK GREY CARPET & NYLON	3,95€		
9999-M064	LIGHT BLUE CARPET & NYLON	3,95€		
9999-M065	BLUE CARPET & NYLON	3,95€		
9999-M066	RED CARPET & NYLON	3,95€		
9999-M067	GREEN CARPET & NYLON	3,95€		
Laminated Parquet with Cheap Board				
9999-M078	PLACED ON OAK CHEAP BOARD	10€		
9999-M078	PLACED ON MAPLE CHEAP BOARD	10€		
Elevated floor with Parquet				
9999-M080	Elevated Floor 12cm covered with Oak Parquet	16€		
9999-M082	Checked alluminum Ceiling	6€		
9999-M083	Lighting beam	2,8€		
9999-M084	Fascia	7€		

SIGNATURE & COMPANY STAMP

NET PRICE

V.A.T. 24%

TOTAL PRICE

DATE

The order is valid only in case that you have proceed a bank deposit 10 days before exhibition's opening day, to the following Bank Account: **ETHNIKI Bank (IBAN: GR13 011 084 000000 840 470 23795)**

Please inform us about your deposit by sending to EXPOSYSTEM the deposit receipt by fax.

Orders which made on site during one day before exhibition's opening day, are fulfilled according our remaining items in storage and the service is according to the orders list.

ORDER FORM WATER SUPPLY

IT HAS TO BE SENT 10 DAYS BEFORE THE OPENING DAY

Please contact: Mrs. Izabela Kuch e-mail: mec@exposystem.gr Mrs. Chletsou e-mail: mchletsou@exposystem.gr

Tel. / Fax: 0030 210 6659741 & 0030 210 3511885

STAND NUMBER :

EXHIBITION : Exhibition Centre

COMPANY NAME : Person at response :

V.A.T. number : **TEL** : **FAX** :

PROFESSION : **ADDRESS** : **P.O**

CODE	DESCRIPTION	€ / ITEM	ITEMS	COST
WATER SUPPLY				
9999-Δ5	WATER SUPPLY - DRAINS	200€		
9999-B7	WATER CONNECTION	50€		
9999-092	SINK WITH CUPBOARD	100€		

SIGNATURE & COMPANY STAMP

NET PRICE

V.A.T. 24%

TOTAL PRICE

DATE

The order is valid only in case that you have proceed a bank deposit 10 days before exhibition's opening day, to the following Bank Account: **ETHNIKI Bank (IBAN: GR13 011 084 000000 840 470 23795)**

Please inform us about your deposit by sending to EXPOSYSTEM the deposit receipt by fax.

Orders which made on site during one day before exhibition's opening day, are fulfilled according our remaining items in storage and the service is according to the orders list.



led spot 12w
code.9999-06



rail of 3 led spots 12W
code.9999-0115



projector of iodine
300W/500W
code.9999-05



projector HQI 150W
code.9999-0125



pylon 4m height
to support 8 spots 150W/500W
or 4 spots 1000W/400W
code.9999-0131



socket up to 0.5KW/220V
socket up to 0.5KW/220V 24h
code.9999-04
code.9999-03



projector HQI 400W
code.9999-0155

Audiovisual



tv plasma 42"-50"-60" with usb
code.9999-446



data video projector
code.9999-01



projection screen 1.80x1.80m
code.9999-01



Dj set
code.9999-02



EXPOSYSTEM
imagine the exhibitions!

5

ORDER FORM ELECTRICAL EQUIPMENT

IT HAS TO BE SENT 10 DAYS BEFORE THE OPENING DAY

Please contact: Mrs. Izabela Kuch e-mail: mec@exposystem.gr Mrs. Chletsou e-mail: mchletsou@exposystem.gr

Tel. / Fax : 0030 210 6659741 & 0030 210 3511885

STAND NUMBER :

EXHIBITION : Exhibition Centre

COMPANY NAME : Person at response :

V.A.T. number : TEL : FAX :

PROFESSION : ADDRESS : P.O.

CODE	DESCRIPTION	€ / ITEM	ITEMS	COST
FOR SCHELL SCHEME STANDS				
9999-M110	LED SPOT 12 WATT	6€		
9999-0115	RAIL WITH 3 SPOT 12 WATT	18€		
9999-05	HALOGEN HEADLAMP 500 WATT	27€		
9999-0125	HQI HEADLAMP 150 WATT	29€		
9999-0155	HQI HEADLAMP 400 WATT	39€		
9999-04	SOCKET OF 220 VOLT / 500 WATT	11€		
9999-03	SOCKET OF 220 VOLT / 500 WATT 24HOUR SUPPLY	12,5€		
9999-01	ELECTRICAL SUPPLY IN KWATT	23,5€		
9999-02	INSTALLATION OF EXHIBITOR'S HEADLAMPS – PER ITEM	5€		
9999-B6	ELECTRICAL BOARD	27,5€		
9999-0131	LIGHTING PILLAR	70€		

SIGNATURE & COMPANY STAMP

NET PRICE

V.A.T. 24%

TOTAL PRICE

DATE.....

NOTES :

1. INSTALLATION AND CONNECTION OF EXHIBITOR'S HEADLAMP IS REALIZED ONLY IN CASE THAT THEY ARE IN GOOD SITUATION, AND THEIR ENDING IS TO EUROPEAN PLUG.
REPAIRS OR WIRINGS OF NEW HEADLAMPS CAN BE ARRANGED AFTER AGREEMENT. DEBITS ARE PER CASE.
2. ELECTRICAL INSTALLATION OF CUSTOMIZED STANDS CAN BE ARRANGED AFTER AGREEMENT, PROVIDED THAT IT IS REQUESTED FROM THE EXHIBITOR, AT LEAST 10 DAYS BEFORE EXHIBITION'S OPENING DATE. DEBITS ARE PER CASE.

The order is valid only in case that you have proceed a bank deposit 10 days before exhibition's opening day, to the following Bank Account: **ETHNIKI Bank (IBAN: GR13 011 084 000000 840 470 23795)**

Please inform us about your deposit by sending to EXPOSYSTEM the deposit receipt by fax.

Orders which made on site during one day before exhibition's opening day, are fulfilled according our remaining items in storage and the service is according to the orders list.

 square truss system 30cm
 code.9999-03

 elevation moteur 100kg
 code.9999-04

6

ORDER FORM LIFTING AND AUDIOVISUAL

IT HAS TO BE SENT 10 DAYS BEFORE THE OPENING DAY
Please contact: Mrs. Izabela Kuch e mail: mec@exposystem.gr Mrs. Chletsou e-mail: mchletsou@exposystem.gr
Tel. / Fax: 0030 210 6659741 & 0030 210 3511885
STAND NUMBER:

EXHIBITION: Exhibition Centre

COMPANY NAME : Person at response :

V.A.T. number : **TEL :** **FAX :**

PROFESSION : **ADDRESS :** **P.O :**

CODE	DESCRIPTION	€ / SQM	ITEMS	COST
9999-03	SQUARE TRUSS SYSTEM	25		
9999-04	ELEVATION MOTEUR 100kg	190		
CODE	DESCRIPTION	€ / ITEM	ITEMS	COST
9999-446	TV PLASMA 42' WITH USB Stick FOR 3 DAYS	120€		
9999-446	TV PLASMA 42' WITH USB Stick FOR 4 DAYS	150€		
9999-01	Data Video Projector for 3 days	460€		
	screen projection 1,80x1,80m			
9999-02	Dj Set for 3 days	480€		

SIGNATURE & COMPANY STAMP
NET PRICE

V.A.T. 24%

TOTAL PRICE

DATE

 The order is valid only in case that you have proceed a bank deposit 10 days before exhibition's opening day, to the following Bank Account: **ETHNIKI Bank (IBAN: GR13 011 084 000000 840 470 23795)**

Please inform us about your deposit by sending to EXPOSYSTEM the deposit receipt by fax.

Orders which made on site during one day before exhibition's opening day, are fulfilled according our remaining items in storage and the service is according to the orders list.

Design the floor plan of the stand

In case you use extra basic alluminum elements or electrical equipment

Exhibition Date:/...../.....

Company nameStand No.

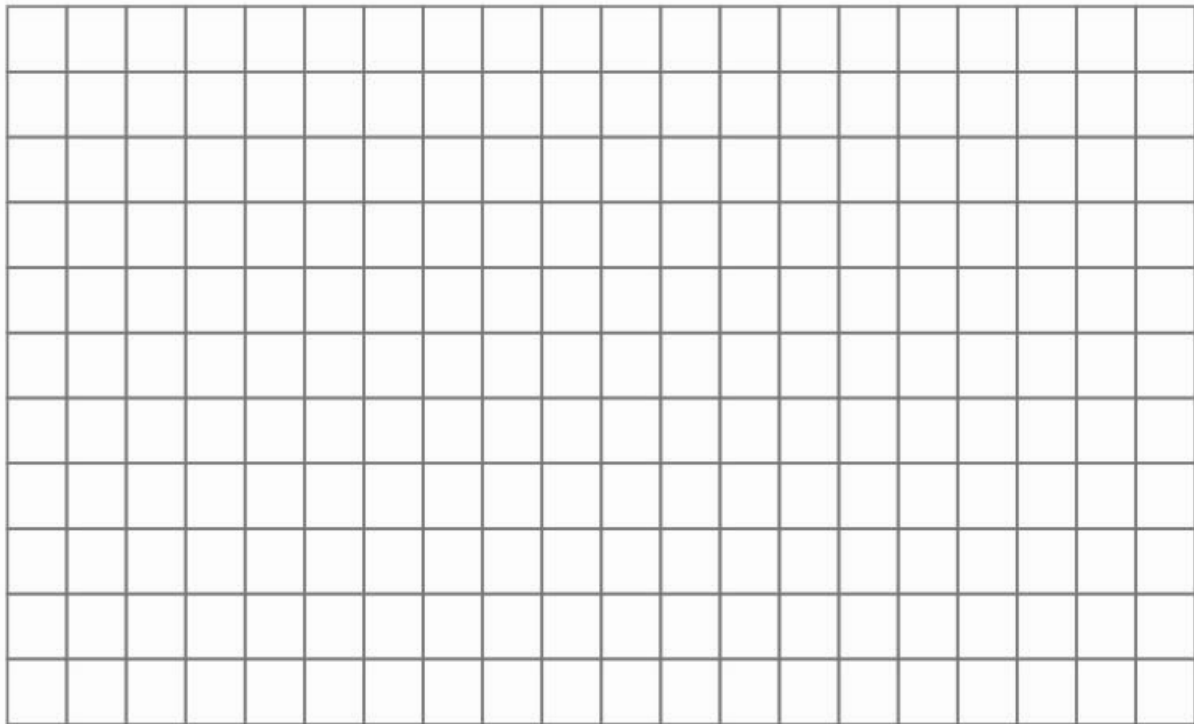

every square is 1.00x1.00m

Symbols

	pvc panel
	folding door
	floor coat hunger
	glass panel
	alluminum door with glass
	oak door
	souko socket 220V/500W
	souko socket 220V/500W 24h
	electrical supply
	iodine projector HQI 500W
	projector HQI 150W
	projector HQI 400W
	mirror spot 100W
	electrical board
	pylon

Example

Stand 6x4m with one view
 There is an office space 2.50x2.00m
 with folding door,
 1 pvc panel and 2 glass panels
 One socker 500watt and 2 iodine
 projectors of 500watt.

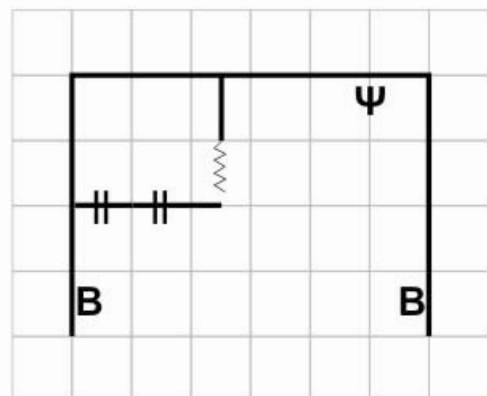



EXPOSYSTEM

WE KNOW HOW

www.exposystem.gr

design

construction

✱ **Thessaloniki Head Office**

154 Egnatia
54 643 Thessaloniki
Greece

T: +30 2310 253160

F: +30 2310 253169

email: exposystem@exposystem.gr

✱ **Athens Branch Office**

1, Samou & Anthousa Av.
153 49 Athens
Greece

T: +30 211 1204400

F: +30 211 1204444

email: secathens@exposystem.gr

✱ **Factory**

Industrial Area of Sindos
570 22 Thessaloniki
Greece

T: +30 2310 797170

F: +30 2310 797171

✱ **MEC exhibition center**

301 Lavriou Street
190 02 Paiania
Greece

T/F: +30 210 6659741

T/F: +30 210 3511885

email: mec@exposystem.gr

